

15.5kV - Voltage and Auxiliary Transformer Fuse Links

Specifications

Description: Voltage transformer fuse links

Ratings:

Rated Voltage: 15.5kV

Rated Current: 3.15A

Breaking Capacity: 32kA

Agency Information: Comply with BS 2692 and IEC 60282-1

Time-Current Curves and Cut-Off Curves: see list page 120 and data on CD at the back of the catalogue.

Dimensions (mm):

Fuse link reference	A mm	B mm	D mm
ABFN*	254	30	25.4
OBFN*	254	30	25.4



Features and Benefits

- *Cool running, low watts loss and power dissipation* thanks to the M-effect ensuring high levels of substation utilisation
- *Silver elements* ensuring high conductivity and low power (revenue) loss
- *100% X-ray*, all our Medium Voltage fuse links are X-rayed ensuring the highest possible standards are maintained

Typical Applications

- Protection of auxiliary transformers

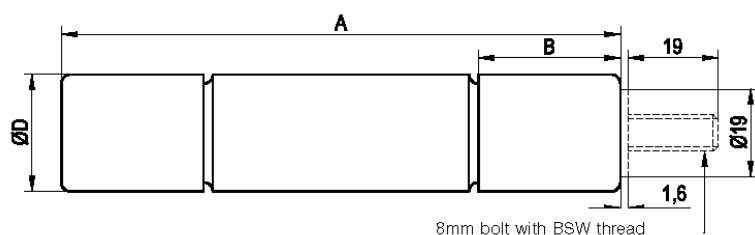

Ferrule fuse links tag type 'A' shown in full lines and '22': tag shown in dotted lines

Part Numbers

Part Number	Rated Current I_n (A)	Breaking Capacity I_1 (kA)	Cold Resistance $m\Omega$	Joule Integral (I^2t)		Length mm	Diameter mm	Weight kg
				Minimum Pre-Arcing	Maximum Operating			
15.5ABFN*3.15	3.15	32	1.24	6.3×10^0	4.0×10^1	254	25.4	0.31
15.5OBFN*3.15	3.15	32	1.24	6.3×10^0	4.0×10^1	254	25.4	0.31

* The last letter of the ordering code on these items is normally either "A" or "22", please refer to how to order page 7 and 8.